

STEP IRONS 250mm x 230mm
x 20mm DIA GALV. MS, GATIC
POLYPROPELENE STEPS (OR EQUIV.)

FRAME AND LID TO BE
TERRA FIRMA TYPE OR
APPROVED EQUIVALENT

STEP IRONS
SEE NOTE 4

PLAN
SCALE 1:20

NOTES:

1. FOR FRAME FIXING DETAILS SEE MANUFACTURES SPECIFICATIONS
2. ALL MEASUREMENTS ARE IN MILLIMETRES.
3. FOR PITS MORE THAN 1.5m DEEP, MINIMUM WALL AND BASE THICKNESS SHALL BE 200mm
4. STEP IRONS TO BE PROVIDED IN ALL PITS OVER 900mm DEEP.
5. WHERE PIPE DIAMETER EXCEEDS 450mm PIT IS TO BE CORBELLED AS PER S-309.
6. CONCRETE STRENGTH F'C = 25MPa.
7. 100mm DIA SEWER CLASS UPVC STUB(S) FOR PROPERTY INLET CONNECTIONS TO BE PROVIDED AS REQUIRED LOCATE STUBS AS APPROPRIATE FOR CONNECTIONS OF PROPERTY INLETS AND HOUSE DRAINS AS DETAILED ON DESIGN CONSTRUCTION PLANS. STUBS TO BE PLACED AT AN APPROPRIATE DEPTH TO ALLOW FOR ACCEPTABLE GRADES AND COVER ON HOUSE DRAINS. (DESIRABLE MINIMUM COVER 500 - 600mm)
8. 600mm x 600mm JUNCTION PIT TO BE USED FOR PIPE DRAINS UP TO 450 DIA AND TO HAVE A MAXIMUM DEPTH OF 900mm

FRAME AND LID TO BE
TERRA FIRMA TYPE OR
APPROVED EQUIVALENT

PROVIDE 100mm DIA UPVC SEWER
CLASS HEAVY (REF AS.1260) STUB(S)
FOR PROPERTY CONNECTIONS AS
REQUIRED. SEE NOTE 7 FOR LOCATION

PIT LID AND FRAME
SEE NOTE 1.

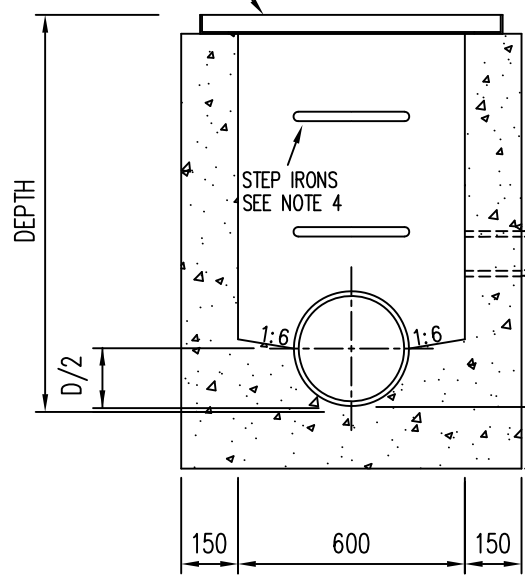

SECTION A-A
SCALE 1:20

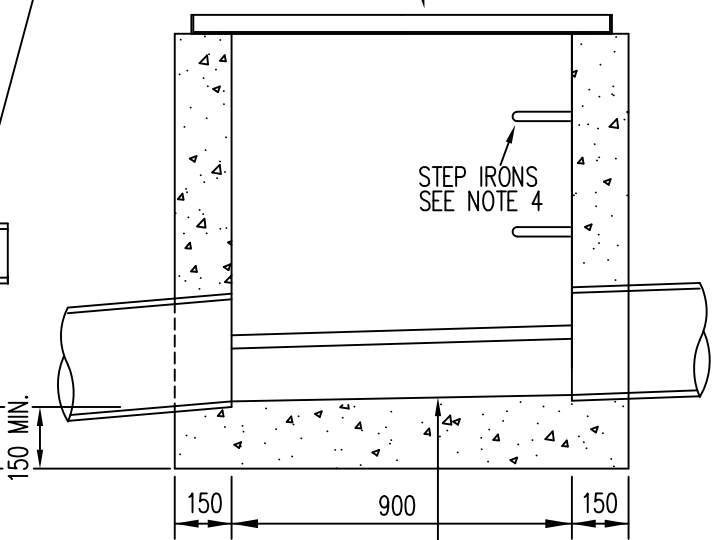

SECTION B-B
SCALE 1:20

CITY OF CASEY

EASEMENT PIT
600mm x 600mm AND 900mm x 600mm

Robert

MANAGER OF ENGINEERING &
ENVIRONMENTAL SERVICES
LAST UPDATE 09.11.2012

AMENDMENTS: GENERAL UPGRADE

S-311

V2